

HiPerFET™ Power MOSFETs

IXFK 73 N 30
IXFN 73 N 30

| V_{DSS} | I_{D25} | $R_{DS(on)}$ |
|-----------|-----------|--------------|
| 300 V | 73 A | 45 mΩ |
| 300 V | 73 A | 45 mΩ |

$t_{rr} \leq 200$ ns

N-Channel Enhancement Mode
Avalanche Rated, High dv/dt, Low t_{rr}

| Symbol | Test Conditions | Maximum Ratings | | |
|------------|--|-----------------|--------|-----------|
| | | IXFK | IXFN | |
| V_{DSS} | $T_J = 25^\circ\text{C}$ to 150°C | 300 | 300 | V |
| V_{DGR} | $T_J = 25^\circ\text{C}$ to 150°C ; $R_{GS} = 1$ MΩ | 300 | 300 | V |
| V_{GS} | Continuous | ±20 | ±20 | V |
| V_{GSM} | Transient | ±30 | ±30 | V |
| I_{D25} | $T_C = 25^\circ\text{C}$ | 73 | 73 | A |
| I_{DM} | $T_C = 25^\circ\text{C}$, pulse width limited by T_{JM} | 292 | 292 | A |
| I_{AR} | $T_C = 25^\circ\text{C}$ | 40 | 40 | A |
| E_{AR} | $T_C = 25^\circ\text{C}$ | 30 | 30 | mJ |
| dv/dt | $I_S \leq I_{DM}$, $di/dt \leq 100$ A/μs, $V_{DD} \leq V_{DSS}$, $T_J \leq 150^\circ\text{C}$, $R_G = 2$ W | 5 | 5 | V/ns |
| P_D | $T_C = 25^\circ\text{C}$ | 500 | 520 | W |
| T_J | | -55 ... +150 | | °C |
| T_{JM} | | | 150 | °C |
| T_{stg} | | -55 ... +150 | | °C |
| T_L | 1.6 mm (0.063 in) from case for 10 s | 300 | - | °C |
| V_{ISOL} | 50/60 Hz, RMS $t = 1$ min | - | 2500 | V~ |
| | $I_{ISOL} \leq 1$ mA $t = 1$ s | - | 3000 | V~ |
| M_d | Mounting torque | 0.9/6 | 1.5/13 | Nm/lb.in. |
| | Terminal connection torque | - | 1.5/13 | Nm/lb.in. |
| Weight | | 10 | 30 | g |

TO-264 AA (IXFK)

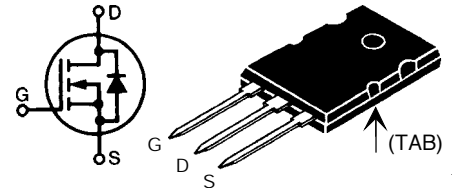

miniBLOC, SOT-227 B (IXFN)

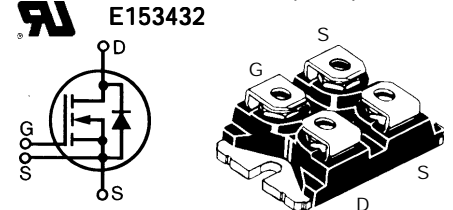

G = Gate
S = Source

D = Drain
TAB = Drain

Either Source terminal at miniBLOC can be used as Main or Kelvin Source

Features

- International standard packages
- JEDEC TO-264 AA, epoxy meet UL94 V-0, flammability classification
- miniBLOC with Aluminium nitride isolation
- Low $R_{DS(on)}$ HDMOS™ process
- Rugged polysilicon gate cell structure
- Unclamped Inductive Switching (UIS) rated
- Low package inductance
- Fast intrinsic Rectifier

Applications

- DC-DC converters
- Synchronous rectification
- Battery chargers
- Switched-mode and resonant-mode power supplies
- DC choppers
- Temperature and lighting controls
- Low voltage relays

Advantages

- Easy to mount
- Space savings
- High power density

| Symbol | Test Conditions | Characteristic Values ($T_J = 25^\circ\text{C}$, unless otherwise specified) | | |
|--------------|--|---|------|---------|
| | | min. | typ. | max. |
| V_{DSS} | $V_{GS} = 0$ V, $I_D = 1$ mA | 300 | | V |
| $V_{GS(th)}$ | $V_{DS} = V_{GS}$, $I_D = 8$ mA | 2 | | V |
| I_{GSS} | $V_{GS} = \pm 20$ V _{DC} , $V_{DS} = 0$ | | | ±200 nA |
| I_{DSS} | $V_{DS} = 0.8$ V_{DSS} , $T_J = 25^\circ\text{C}$ | | | 400 uA |
| | $V_{GS} = 0$ V, $T_J = 125^\circ\text{C}$ | | | 2 mA |
| $R_{DS(on)}$ | $V_{GS} = 10$ V, $I_D = 0.5$ I_{D25} Pulse test, $t \leq 300$ μs, duty cycle $d \leq 2$ % | | | 45 mΩ |

| Symbol | Test Conditions | Characteristic Values ($T_J = 25^\circ\text{C}$, unless otherwise specified) | | |
|--------------|--|---|------|------|
| | | min. | typ. | max. |
| g_{fs} | $V_{DS} = 10\text{ V}; I_D = 0.5 I_{D25}$, pulse test | | 50 | S |
| C_{iss} | $V_{GS} = 0\text{ V}, V_{DS} = 25\text{ V}, f = 1\text{ MHz}$ | | 9000 | pF |
| C_{oss} | | | 1500 | pF |
| C_{rss} | | | 580 | pF |
| $t_{d(on)}$ | $V_{GS} = 10\text{ V}, V_{DS} = 0.5 V_{DSS}, I_D = 0.5 I_{D25}$ $R_G = 1\ \Omega$ (External), | | 30 | ns |
| t_r | | | 80 | ns |
| $t_{d(off)}$ | | | 100 | ns |
| t_f | | | 50 | ns |
| $Q_{g(on)}$ | $V_{GS} = 10\text{ V}, V_{DS} = 0.5 V_{DSS}, I_D = 0.5 I_{D25}$ | | 360 | nC |
| Q_{gs} | | | 60 | nC |
| Q_{gd} | | | 180 | nC |
| R_{thJC} | TO-264 AA | | 0.25 | K/W |
| R_{thCK} | TO-264 AA | 0.15 | | K/W |
| R_{thJC} | miniBLOC, SOT-227 B | | 0.24 | K/W |
| R_{thCK} | miniBLOC, SOT-227 B | 0.05 | | K/W |

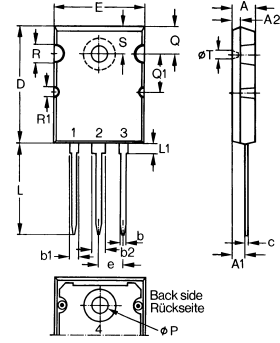
TO-264 AA Outline

| Dim. | Millimeter | | Inches | |
|------|------------|-------|----------|-------|
| | Min. | Max. | Min. | Max. |
| A | 4.82 | 5.13 | .190 | .202 |
| A1 | 2.54 | 2.89 | .100 | .114 |
| A2 | 2.00 | 2.10 | .079 | .083 |
| b | 1.12 | 1.42 | .044 | .056 |
| b1 | 2.39 | 2.69 | .094 | .106 |
| b2 | 2.90 | 3.09 | .114 | .122 |
| c | 0.53 | 0.83 | .021 | .033 |
| D | 25.91 | 26.16 | 1.020 | 1.030 |
| E | 19.81 | 19.96 | .780 | .786 |
| e | 5.46 BSC | | .215 BSC | |
| J | 0.00 | 0.25 | .000 | .010 |
| K | 0.00 | 0.25 | .000 | .010 |
| L | 20.32 | 20.83 | .800 | .820 |
| L1 | 2.29 | 2.59 | .090 | .102 |
| P | 3.17 | 3.66 | .125 | .144 |
| Q | 6.07 | 6.27 | .239 | .247 |
| Q1 | 8.38 | 8.69 | .330 | .342 |
| R | 3.81 | 4.32 | .150 | .170 |
| R1 | 1.78 | 2.29 | .070 | .090 |
| S | 6.04 | 6.30 | .238 | .248 |
| T | 1.57 | 1.83 | .062 | .072 |

| Symbol | Test Conditions | Characteristic Values ($T_J = 25^\circ\text{C}$, unless otherwise specified) | | |
|----------|--|---|------|---------------|
| | | min. | typ. | max. |
| I_s | $V_{GS} = 0\text{ V}$ | | 73 | A |
| I_{SM} | Repetitive; pulse width limited by T_{JM} | | 292 | A |
| V_{SD} | $I_F = 100\text{ A}, V_{GS} = 0\text{ V}$, Pulse test, $t \leq 300\ \mu\text{s}$, duty cycle $d \leq 2\%$ | | 1.5 | V |
| t_{rr} | $I_F = I_s, -di/dt = 100\text{ A}/\mu\text{s}, V_R = 100\text{ V}$ | | 2 | ns |
| Q_{RM} | | | 40 | μC |
| I_{RM} | | | | A |

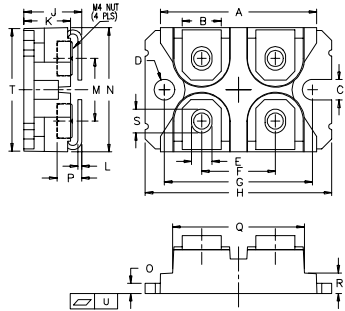
miniBLOC, SOT-227 B

M4 screws (4x) supplied

| Dim. | Millimeter | | Inches | |
|------|------------|-------|--------|-------|
| | Min. | Max. | Min. | Max. |
| A | 31.50 | 31.88 | 1.240 | 1.255 |
| B | 7.80 | 8.20 | 0.307 | 0.323 |
| C | 4.09 | 4.29 | 0.161 | 0.169 |
| D | 4.09 | 4.29 | 0.161 | 0.169 |
| E | 4.09 | 4.29 | 0.161 | 0.169 |
| F | 14.91 | 15.11 | 0.587 | 0.595 |
| G | 30.12 | 30.30 | 1.186 | 1.193 |
| H | 38.00 | 38.23 | 1.496 | 1.505 |
| J | 11.68 | 12.22 | 0.460 | 0.481 |
| K | 8.92 | 9.60 | 0.351 | 0.378 |
| L | 0.76 | 0.84 | 0.030 | 0.033 |
| M | 12.60 | 12.85 | 0.496 | 0.506 |
| N | 25.15 | 25.42 | 0.990 | 1.001 |
| O | 1.98 | 2.13 | 0.078 | 0.084 |
| P | 4.95 | 5.97 | 0.195 | 0.235 |
| Q | 26.54 | 26.90 | 1.045 | 1.059 |
| R | 3.94 | 4.42 | 0.155 | 0.174 |
| S | 4.72 | 4.85 | 0.186 | 0.191 |
| T | 24.59 | 25.07 | 0.968 | 0.987 |
| U | -0.05 | 0.1 | -0.002 | 0.004 |

IXYS reserves the right to change limits, test conditions, and dimensions.

 IXYS MOSFETs and IGBTs are covered by one or more of the following U.S. patents: 4,835,592 4,881,106 5,017,508 5,049,961 5,187,117 5,486,715
 4,850,072 4,931,844 5,034,796 5,063,307 5,237,481 5,381,025

Fig. 1 Output Characteristics

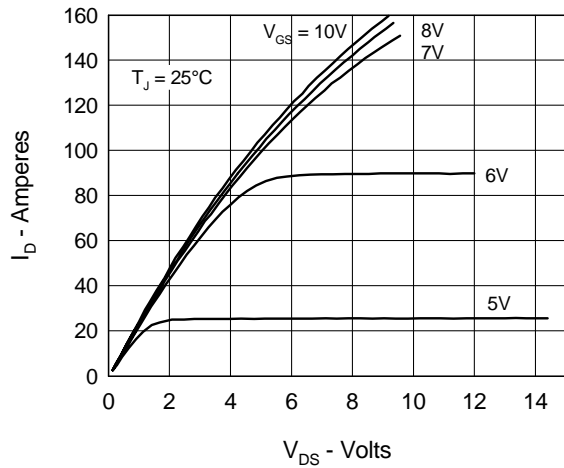

Fig. 2 Input Admittance

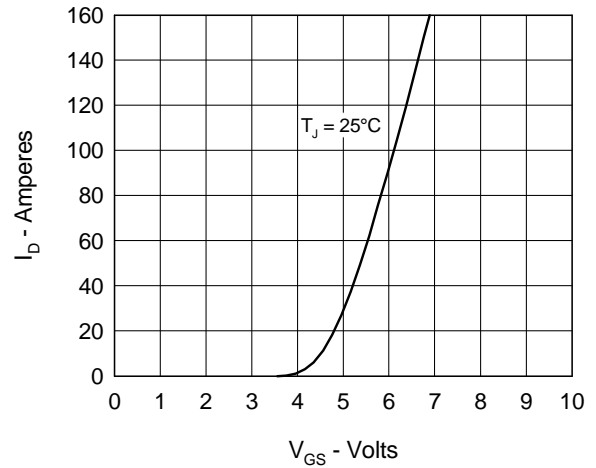

Fig. 3 $R_{DS(on)}$ vs. Drain Current

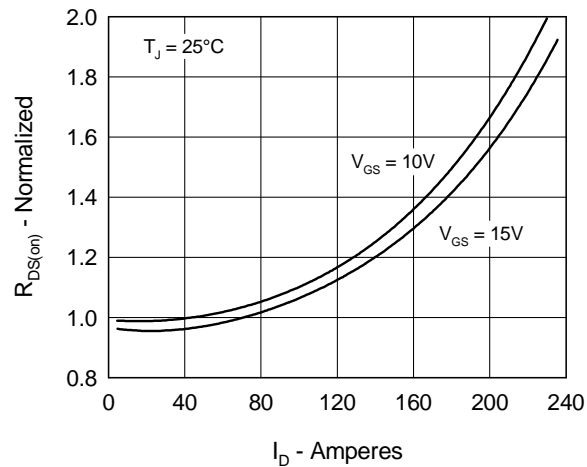

Fig. 4 Temperature Dependence of Drain to Source Resistance

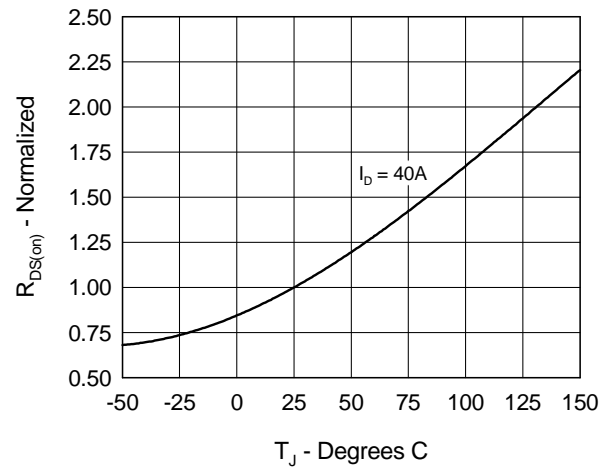

Fig. 5 Drain Current vs. Case Temperature

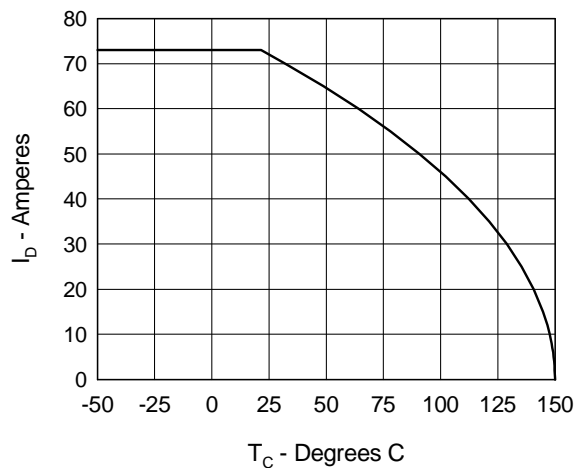

Fig. 6 Temperature Dependence of Breakdown and Threshold Voltage

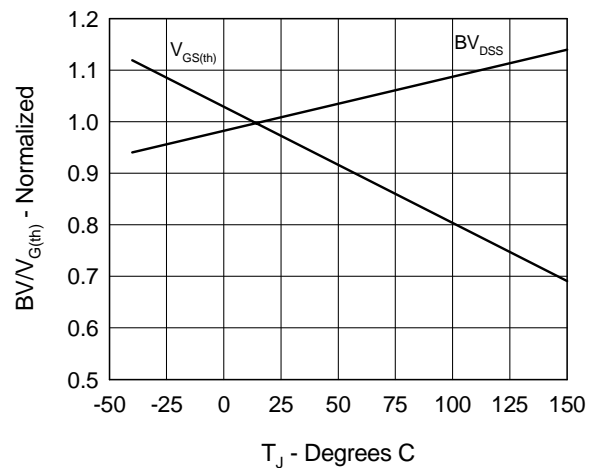

Fig.7 Gate Charge Characteristic Curve

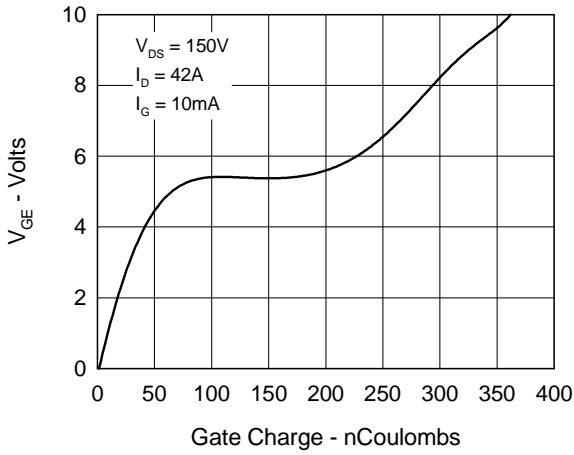

Fig.8 Capacitance Curves

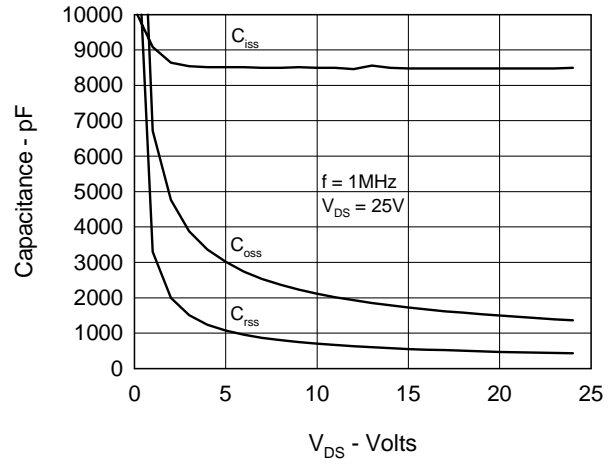

Fig.9 Source Current vs. Source to Drain Voltage

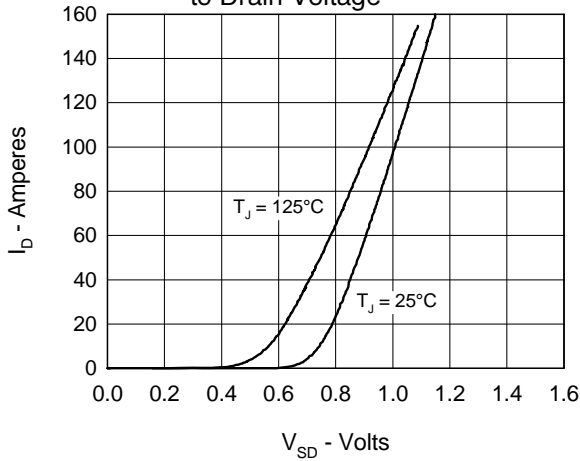
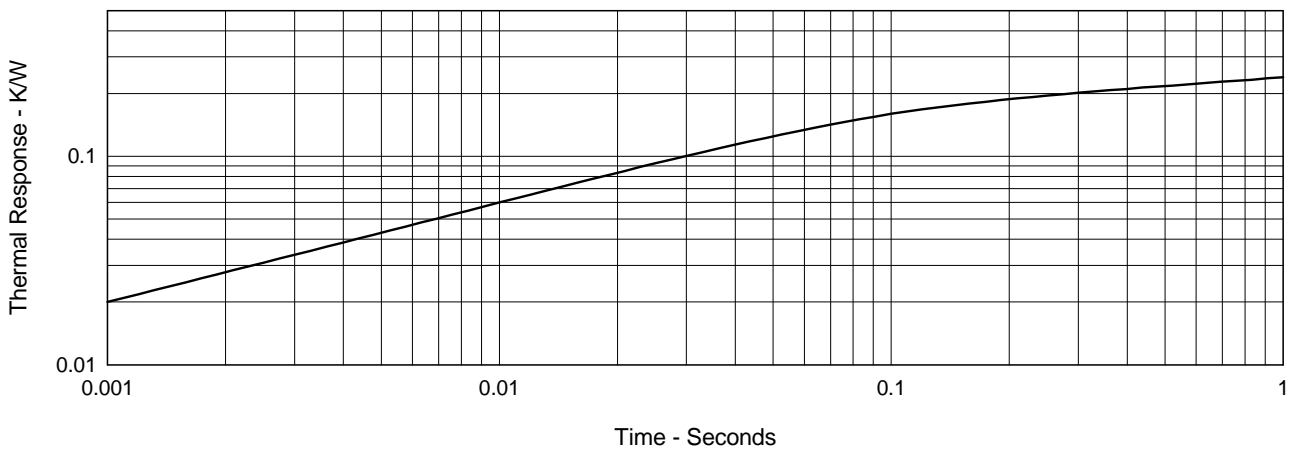

Fig.10 Transient Thermal Impedance



IXYS reserves the right to change limits, test conditions, and dimensions.

IXYS MOSFETS and IGBTs are covered by one or more of the following U.S. patents: 4,835,592 4,881,106 5,017,508 5,049,961 5,187,117 5,486,715
4,850,072 4,931,844 5,034,796 5,063,307 5,237,481 5,381,025

Mouser Electronics

Authorized Distributor

Click to View Pricing, Inventory, Delivery & Lifecycle Information:

[IXYS:](#)

[IXFK73N30](#) [IXFN73N30](#)